

The CMOS laser displacement sensors LC-S series

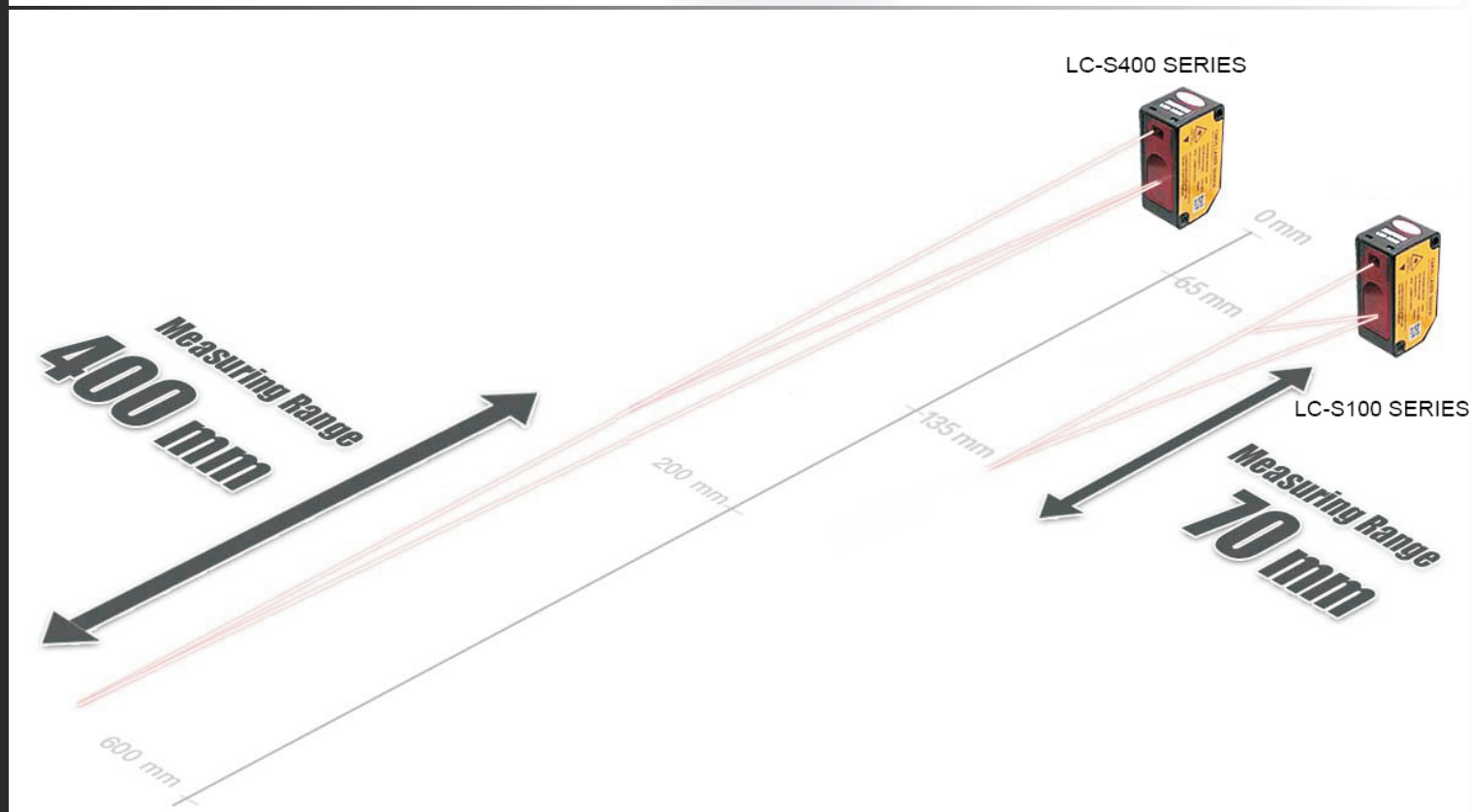

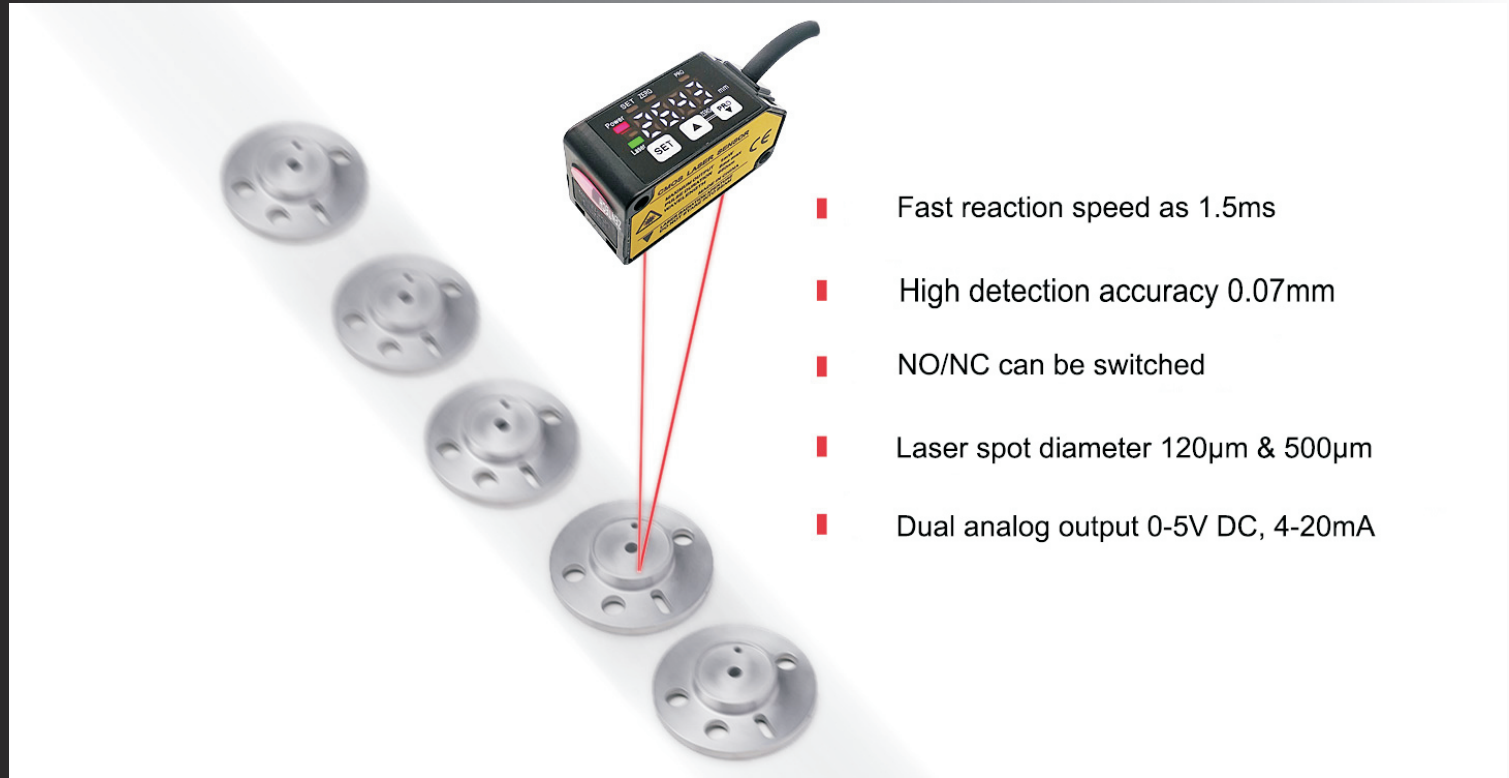

LC-S series Laser Displacement Sensors

Sensing the smallest

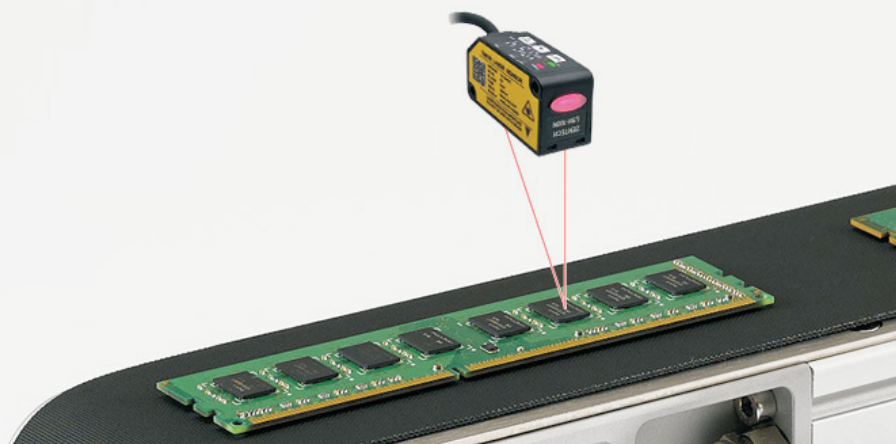

Output Status



Power indicator

Laser Emission Indicator

Teaching Button

Measurement Value



Pro-Mode Zero Function

● Direction relative to the moving object

<In the case of material and colour difference.>

• When measuring, when the material and color of the moving object are extremely different, the measurement error can be controlled to a minimum by installing it in the direction shown in the following figure.

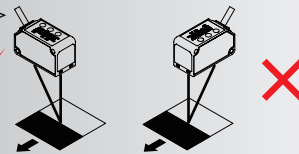

<Measuring rotating objects.>

• When measuring a rotating object, please install it in the direction shown in the figure below, so as to restrain the influence of up-down vibration and position offset of the object.

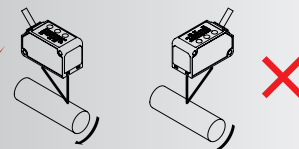

<In the case of step difference.>

• In the case of moving measurement object with step difference, install it according to the method shown in the figure below, so as to restrain the influence of step difference edge.

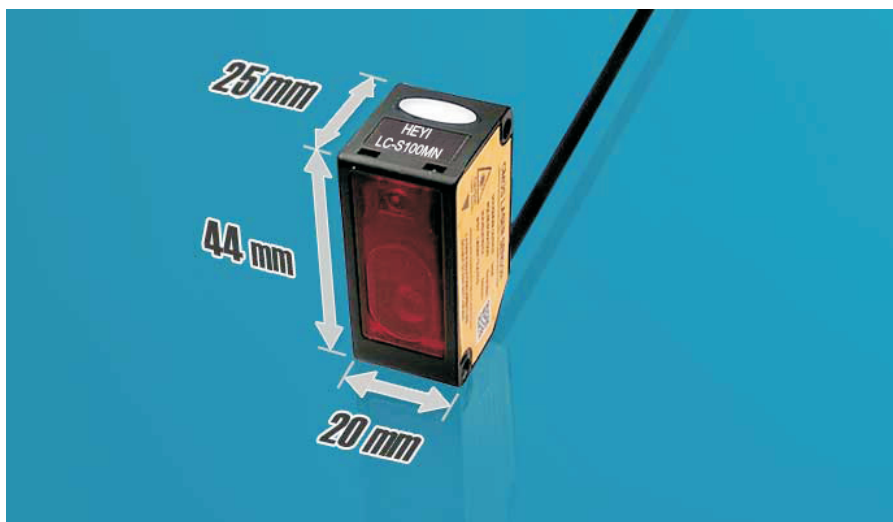
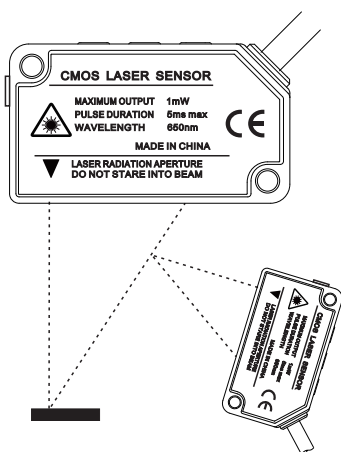
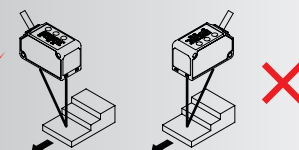

■ Input and Output Circuit Diagram

● NPN output

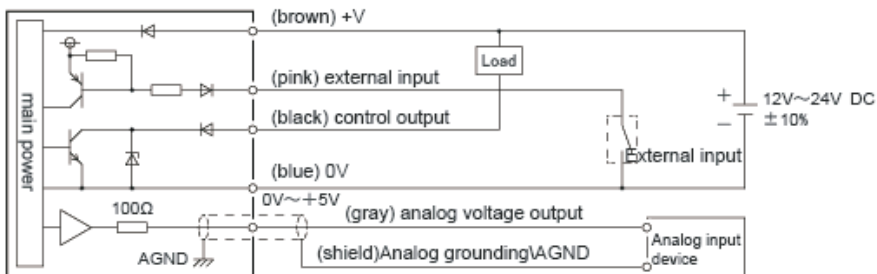

● PNP output

